

REQUEST for QUALIFICATIONS

ALL PROSPECTIVE MANUFACTURING FIRMS

INVITATION for QUALIFICATIONS

GHS-FD Project #: GRADY HEADWALLS, BED LOCATORS, BOOMS, AND UTILITY WALL SYSTEMS 21502

Grady offers the best surgical care in Atlanta, that is backed by a level 1 trauma center. Our unparalleled experience in traditional surgery is matched by our familiarity with minimally invasive procedures, including laparoscopic and robotic surgery.

The Grady Surgery Center performs more than 14,000 procedures a year, including hundreds of challenging and time-sensitive procedures to treat patients of trauma, such as auto accidents and industrial mishaps. This unparalleled experience means that Grady has the most experienced surgeons in Atlanta. Surgical Specialties include:

- Trauma and Burns
- Breast
- Cancer
- Cardiac (heart)
- Colorectal (colon and rectum)
- Endocrine (thyroid and adrenal glands)
- General and gastrointestinal (GI)
- Gynecologic
- Neurologic (brain and spine)
- Ophthalmology (eye)
- Maxillofacial (oral or dental)
- Otolaryngology (head and neck)
- Orthopedic (hips, elbows, shoulders, and joints)
- Thoracic (lungs, chest, esophagus, and diaphragm)
- Urology
- Vascular and endovascular (blood vessels and lymph system)

Currently Grady staff's five primary procedural areas (one new proposed) on four floors:

Surgery Location	Current Program	Proposed (18-24 months)	Location
Main OR	➤ 16 OR's ➤ 01 Hybrid OR	➤ Six new OR's ➤ Renovate 15 OR's	Sixth Floor JKL
Labor and Delivery	➤ 6 OR's	➤ n/a	Fourth Floor JKL
Burn OR Suite	➤ proposed	➤ Two new OR's	Third Floor GEF
HDR Procedural Suite	➤ 2 Special Procedure Rooms	➤	Third Floor GEF

IR Suite	➤ 2 IR Rooms	➤ One new IR Room	Third Floor GEF
Cath Labs	➤ 3 Cath Lab's	➤ Renovate 1 Lab	Second Floor GEF

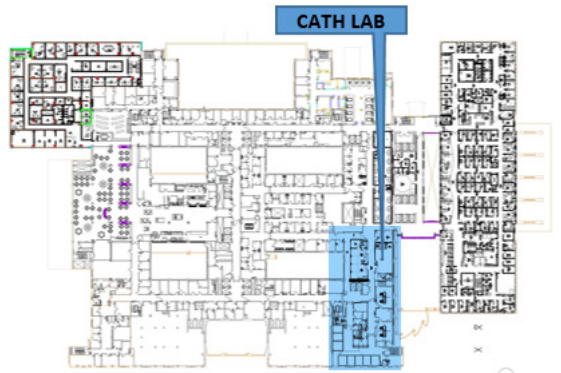

SECOND FLOOR

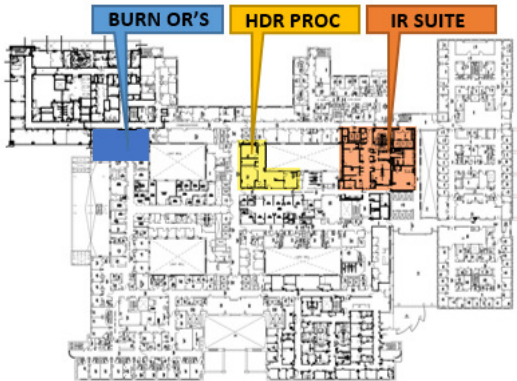

THIRD FLOOR

CATH Lab Suite – Second Floor

Currently Grady staff's 3 CATH Labs, built in the 1990's. The design of the existing CATH LAB Suite includes a group of three LAB's within a sterile suite. The LAB's range in size from 305 SF to 515 SF. Over the 35 year use of the CATH Lab space has served the clinical need, but the current limitations per room and an inability to advance technology will warrant a future renovation. The rooms will need to be right-sized to accommodate a future renovation, but the current capacity of three rooms meets the clinical need.

Burn OR Suite – Third Floor

Currently Grady utilizes the main OR for burn procedures. The design of the BURN Expansion includes a new OR Suite with two new OR's on the third floor. The new OR Suite will be immediately adjacent to the Burn Center and includes to 400 SF operating rooms.

HDR Suite – Third Floor

A recent upgrade in facilities built out a new procedural suite with two special procedure rooms on the third floor, ranging in size from 325 SF to 420 SF. This space serves the current clinical need.

IR Suite – Third Floor

A recent upgrade in facilities built out a new procedural suite with two IR procedure rooms on the third floor, approximately 450 SF in size. The upgrade also set the boundary for a third new IR procedural suite, to be built-out next year. This space serves the current clinical need, but will need to grow with the service line.

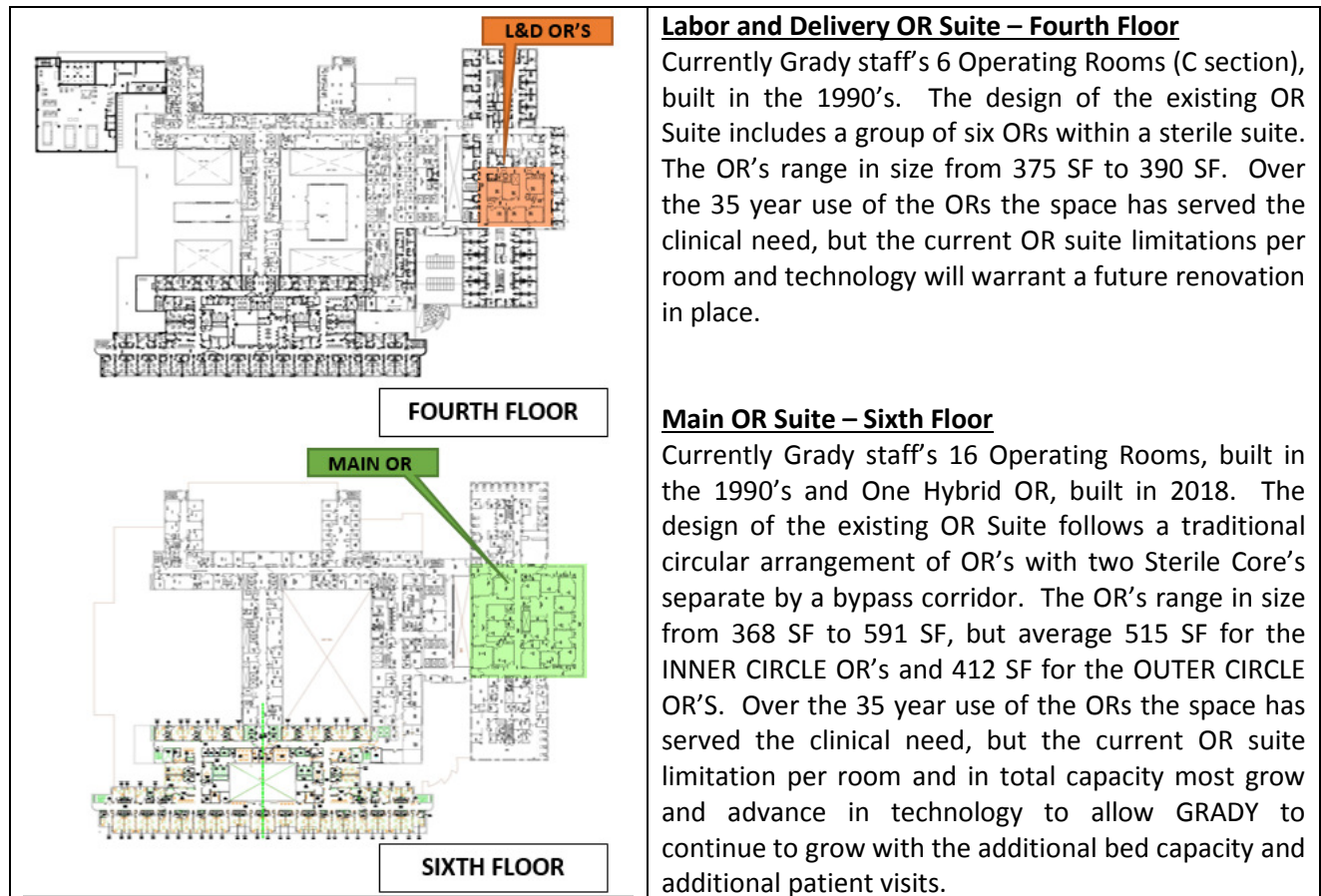

Labor and Delivery OR Suite – Fourth Floor

Currently Grady staff's 6 Operating Rooms (C section), built in the 1990's. The design of the existing OR Suite includes a group of six ORs within a sterile suite. The OR's range in size from 375 SF to 390 SF. Over the 35 year use of the ORs the space has served the clinical need, but the current OR suite limitations per room and technology will warrant a future renovation in place.

Main OR Suite – Sixth Floor

Currently Grady staff's 16 Operating Rooms, built in the 1990's and One Hybrid OR, built in 2018. The design of the existing OR Suite follows a traditional circular arrangement of OR's with two Sterile Core's separate by a bypass corridor. The OR's range in size from 368 SF to 591 SF, but average 515 SF for the INNER CIRCLE OR's and 412 SF for the OUTER CIRCLE OR'S. Over the 35 year use of the ORs the space has served the clinical need, but the current OR suite limitation per room and in total capacity most grow and advance in technology to allow GRADY to continue to grow with the additional bed capacity and additional patient visits.

Phase 2 - OR CEILING SYSTEMS

Design and build a ceiling, light, and boom replacement.

Facilities Development is soliciting "Qualifications" for OR CEILING SYSTEMS.

All firms and/or manufacturers planning to submit a proposal must be pre-qualified or submit qualifications for consideration. To become qualified, please submit a qualifications package meeting the following requirements:

- Capabilities – Must be experienced with designing and building healthcare occupancy improvements within an active healthcare setting, performing field verifications without interruption to the facility.
- List of three to five healthcare Inpatient, Critical/Intensive Care projects of similar size and scale.
- Brief narrative of each of the referenced projects.
- Organization chart of your team.
- *We are looking for the actual team members you would plan to assign to this project.*
- One page CV or resume of each team member.

The following manufacturers/systems have been determined to be pre-qualified.

- [SLD](#)
- ["AIRFRAME"](#)
- Manufactured OR Ceiling
- [Price Industries](#)
- ["ULTRASUITE"](#)
- Manufactured OR Ceiling
- [AJ Manufacturing](#)
- ["SS-CARES"](#)
- Manufactured OR Ceiling
- [Steris](#)
- ["CLEANSUITE"](#)
- Manufactured OR Ceiling
- [Mfphd](#)
- ["FORTRESS"](#)
- Wall cladding

** In no particular order*

The project will be located on the third floor and fourth floor mechanical penthouse of the main hospital.

- 80 Jesse Hill Jr. Drive, SE, Atlanta, GA 30303.

Additionally, registration with VendorMate and TIER 1 Diversity forms must also be completed in order to be considered pre-qualified.

Please submit qualifications packages to Evan Rodriguez by email at erodriguez2@gmh.edu Attn. Tom Lemieux, by c.o.b. October 19th, 2023.

You will be notified if you have met the threshold for being qualified no later than Monday, October 23rd, 2023.

A mandatory pre-proposal meeting will be held Monday, October 30th, 2023, 1:00 pm

Mandatory Pre-Proposal Meeting: Facilities Development Conference Room, Third Floor, Hurt Building, 50 Hurt Plaza SE, Atlanta, Georgia, 30303, followed by tour of job-site, Third Floor of Grady Memorial Hospital, 80, Jesse Hill, Jr., Drive SE, Atlanta, Georgia, 30303.

Proposals due Thursday, December 7th, 2023, by 2:00 pm bids due in the offices of Facilities Development, Third Floor, Hurt Building, 50 Hurt Plaza SE, Atlanta, Georgia, 30303, Attn. Tom Lemieux and by email at erodriguez2@gmh.edu and tglemieux@gmh.edu

Local, Small Economically Disadvantaged Business Utilization

It is an overall objective of The Grady Memorial Hospital Corporation, d/b/a Grady Health System (GHS) to encourage involvement by local, small, economically disadvantaged contractors and suppliers in business activities generated by GHS®, while assuring that such activities will be conducted in accordance with all applicable laws. It is the declared policy and intent of GHS® to strive to maximize participation of local, small, economically disadvantaged businesses through all business contracting opportunities. GHS® is committed to ensuring that local, small, economically disadvantaged businesses are given every opportunity to participate in contracting opportunities.

GHS® prohibits discrimination on the basis of race, color, gender, religion, national origin, or disability in connection with employment of any person, or the award of any contract. GHS® will provide equal opportunities without regard to race, color, gender, religion, national origin, or disability, by requiring that any vendor doing business with GHS® provide equal opportunity to persons and businesses employed by, or contracting with the supplier of products and services to GHS®.

GHS® expects that the policies, programs and practices of its vendors/contractors are carried out in an equitable fashion and that local (Fulton County, DeKalb County, State of Georgia), small and economically disadvantaged business enterprises are afforded an equitable opportunity to share in contract/subcontract opportunities.

These documents are considered a part of and should be submitted with the qualifications package. Failure to provide the requested information will result in the proposal being determined non-responsive.

- **Screen shot or copy of Vendormate certificate**
- **Completed TIER 1 Diversity form**
- **Certificate verifying TIER 1 diversity.**
- **List of three to five design-build projects of similar size and scale.**
- **Brief narrative of each of the referenced projects.**
- **Organization chart of your team**
- **One page CV or resume of each team member.**

PROCESS FOR SELECTION

A selection team will evaluate each qualification submitted and score the team member. The scores will be made available upon request for your team following pre-qualification

GHS-FD reserves the unqualified right to request additional information or meetings with any architect, engineer, or contractor.

Your company wishes to be pre-qualified or qualified as a:

- ☐ CEILING MANUFACTURER
- ☐ OTHER COMPLIMENTARY PRODUCTS

NAME: _____

TITLE: _____

PHONE: () _____

EMAIL: _____

SIGNATURE: _____

DATE: _____