

REQUEST for QUALIFICATIONS

PHASE 1 - ALL PROSPECTIVE HELIPAD SUPPLIER/INSTALLER

PHASE 2 - ALL PROSPECTIVE ARCHITECTURAL / ENGINEERING / GENERAL CONTRACTING FIRMS

INVITATION for QUALIFICATIONS

**GHS-FD Project #: GRADY NEW HELIPAD BUILDING A
21502**

With the ongoing Grady bed expansion and the recent closure of AMC, Atlanta's only other LEVEL 1 Trauma Center, it is essential that GRADY have an ability to have multiple medical flight teams INBOUND and OUTBOUND to serve the needs of the community. A brief overview of the project is further into this document.

Phase 1

Grady Health System Department of Facilities Development is soliciting "Qualifications" Full Service Supplier/Installer for a new Helipad to be installed on the sixteenth floor roof of the main hospital building A, otherwise known as WEST TOWER. The HELIPAD SYSTEM will be purchased as a PHASE 1 and then the AEC teams will design a design build solution around this installation for PHASE 2.

All INSTALLER/SUPPLIER to submit for PHASE 1 must be pre-qualified. To become qualified, please submit a qualifications package meeting the following requirements:

- List of three to five projects of similar size and scale.
- Brief narrative of each of the referenced projects.
- Organization chart of your team
- One page CV or resume of each team member.

The following INSTALLERS/SUPPLIERS have been determined to be pre-qualified.

- [Heliport Systems Inc.](#)
- [FEC Heliports](#)

Phase 2

Grady Health System Department of Facilities Development is soliciting "Qualifications" Full Service A/E/C services for a renovation and installation of our new Helipad to be placed on the sixteenth floor roof of the main hospital building A, otherwise known as WEST TOWER.

All A/E/C firms planning to partner and submit a proposal must be pre-qualified. To become qualified, please submit a qualifications package meeting the following requirements:

- List of three to five design-build projects of similar size and scale.
- Brief narrative of each of the referenced projects.
- Organization chart of your team.

- *We are looking for the actual team members you would plan to assign to this project.*
- One page CV or resume of each team member.

The following A/E/C have been determined to be pre-qualified.

- [Turner](#)
- [Beck](#)
- [Cork Howard](#)
- [TVS](#)
- [Beck](#)
- [TLC](#)
- [SSR](#)
- [WSP](#)

** In no particular order*

The project will be located in the clinic building of the main hospital.

- 80 Jesse Hill Jr. Drive, SE, Atlanta, GA 30303.

Additionally, registration with VendorMate and TIER 1 Diversity forms must also be completed in order to be considered pre-qualified.

Please submit qualifications to Evan Rodriguez by email at erodriguez2@gmh.edu by c.o.b. May 19th, 2023. You will be notified if you have met the threshold for being pre-qualified.

A pre-proposal meeting will be held Tuesday May 23rd at 10:00am at Hurt Building.

LEGEND:

Bundle #1 – CASS BACKFILL AND REFRESH

Bundle #3 – ENABLING

Bundle #2 – EAST TOWER

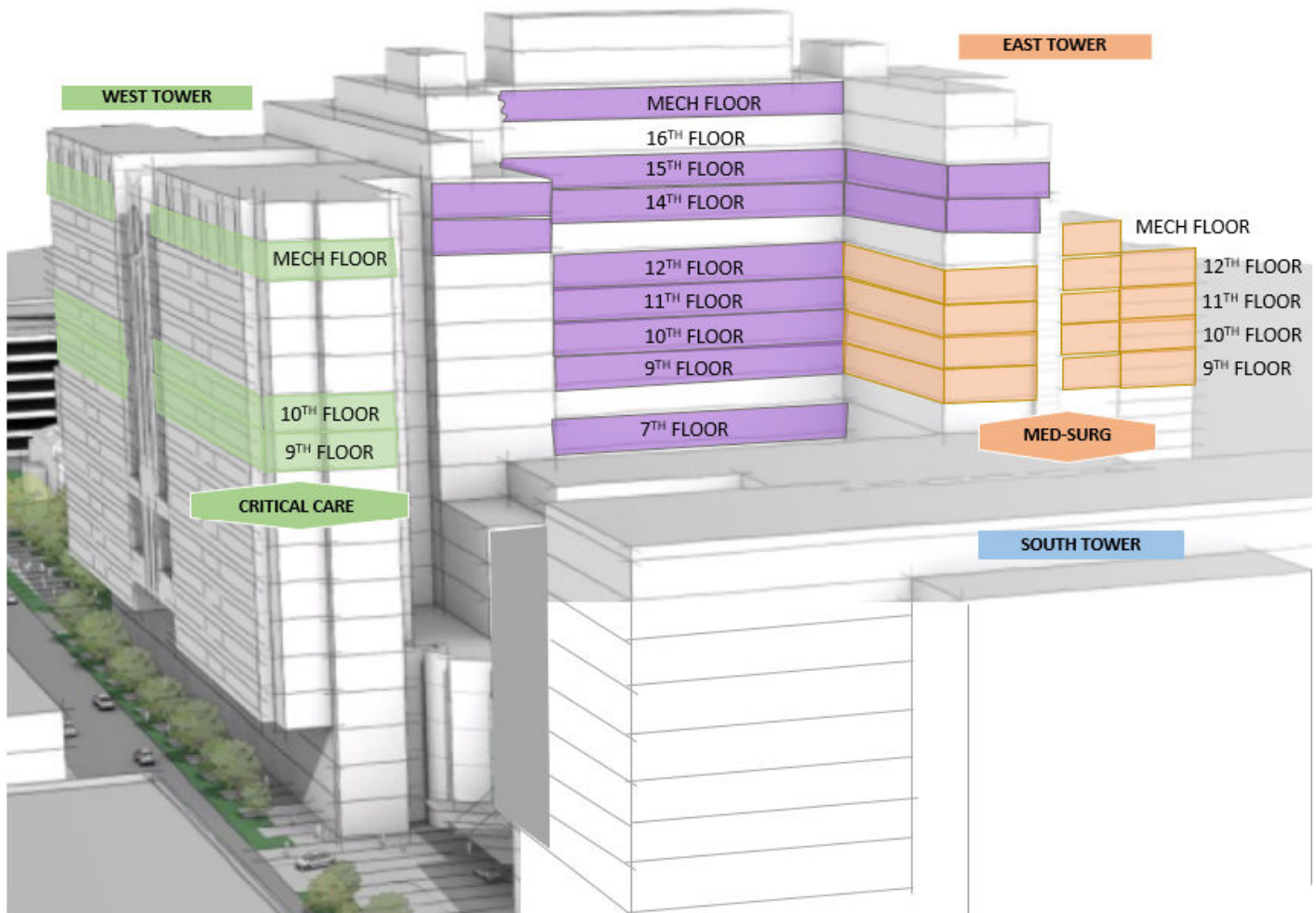

FOR REFERENCE ONLY

Figure #1 – Grady Bed Expansion

NEW GRADY HELIPAD \$6.5M to \$7.5M



SCOPE DEFINITION:

- 1 NEW PATIENT TRANSPORT ELEVATOR
- 2 NEW HELIPAD
- 3 NEW FUEL RECOVERY TANK
- 4 NEW FIRE SUPPRESSION SYSTEM
- 5 STRUCTURAL REINFORCEMENT BELOW
- 6 NEW RAMP AND LANDING TO MEZZANINE
- 7 HEATED SURFACE FOR RAMP



COST ESTIMATE:

CONSTRUCTION	\$ 4.5 M
DESIGN	INCL'D
EQUIPMENT	\$ 300 K
INFRA	\$ 600 K
CONT	\$ 600 K
SUBTOTAL	\$ 7.5 M



TIMELINE:

CONSTRUCTION CAN COMMENCE IN THREE MONTHS

PENDING BOARD APPROVAL

THE DURATION IS APPROXIMATELY SEVEN MONTHS



Grady Memorial Hospital Helipad
Apr 19, 2012 | Hospital Heliports, Rooftop Heliports

Permanent, approved heliports at hospitals are essential for safe and efficient transport of patients. Heliport Systems, Inc. is highly experienced in working with hospitals in establishing heliports which are close to patient treatment areas, safe for pilots,...

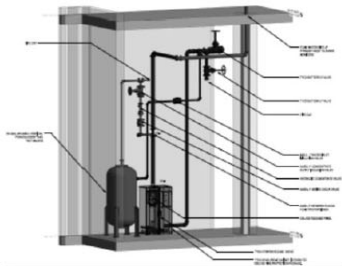

20220922_101626_photo
Taken on:
Sep 22, 2022 10:16 AM

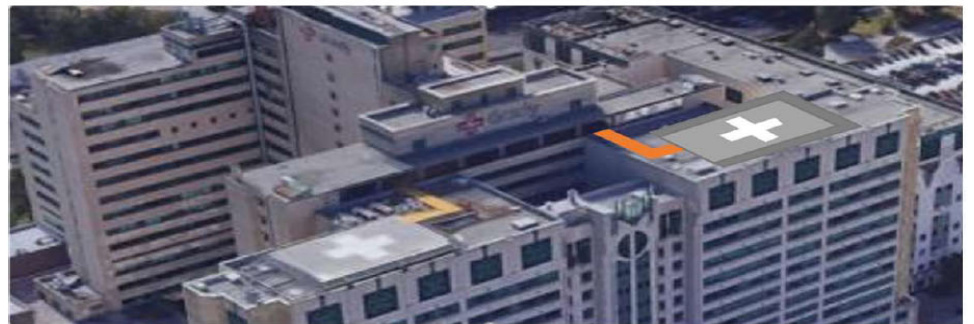
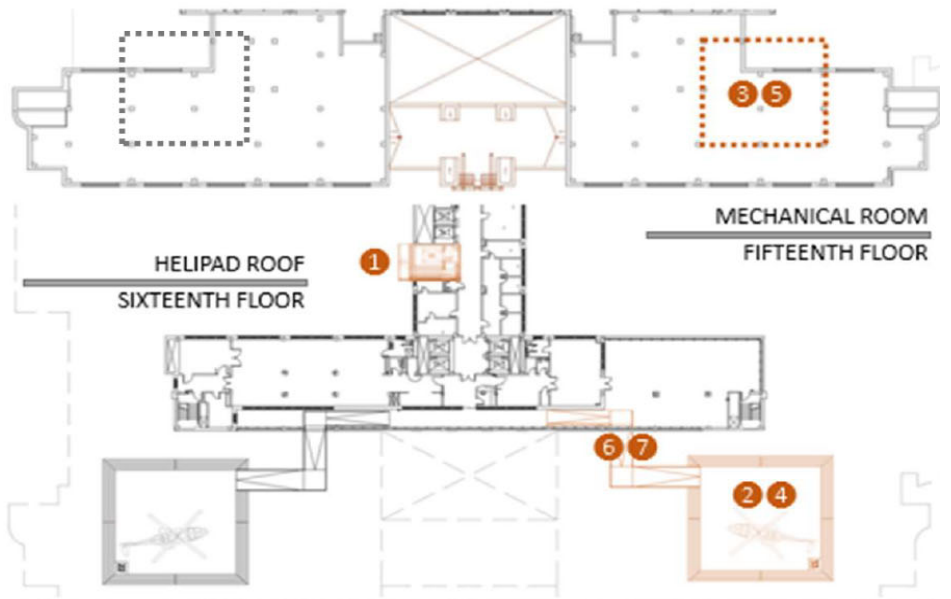

Figure #2 – Grady Helipad Concept

Local, Small Economically Disadvantaged Business Utilization

It is an overall objective of The Grady Memorial Hospital Corporation, d/b/a Grady Health System (GHS) to encourage involvement by local, small, economically disadvantaged contractors and suppliers in business activities generated by GHS®, while assuring that such activities will be conducted in accordance with all applicable laws. It is the declared policy and intent of GHS® to strive to maximize participation of local, small, economically disadvantaged businesses through all business contracting opportunities. GHS® is committed to ensuring that local, small, economically disadvantaged businesses are given every opportunity to participate in contracting opportunities.

GHS® prohibits discrimination on the basis of race, color, gender, religion, national origin, or disability in connection with employment of any person, or the award of any contract. GHS® will provide equal opportunities without regard to race, color, gender, religion, national origin, or disability, by requiring that any vendor doing business with GHS® provide equal opportunity to persons and businesses employed by, or contracting with the supplier of products and services to GHS®.

GHS® expects that the policies, programs and practices of its vendors/contractors are carried out in an equitable fashion and that local (Fulton County, DeKalb County, State of Georgia), small and economically disadvantaged business enterprises are afforded an equitable opportunity to share in contract/subcontract opportunities.

These documents are considered a part of and should be submitted with the qualifications package. Failure to provide the requested information will result in the proposal being determined non-responsive.

- **Screen shot or copy of Vendormate certificate**
- **Completed TIER 1 Diversity form**
- **Certificate verifying TIER 1 diversity.**
- **List of three to five design-build projects of similar size and scale.**
- **Brief narrative of each of the referenced projects.**
- **Organization chart of your team**
- **One page CV or resume of each team member.**

PROCESS FOR SELECTION

A selection team will evaluate each qualification submitted and score the team member. The scores will be made available upon request for your team following pre-qualification

GHS-FD reserves the unqualified right to request additional information or meetings with any architect, engineer, or contractor.

Your company wishes to be pre-qualified as a:

- Architect
- Engineer
- General Contractor
- HELIPAD Full Service Supplier
- HELIPAD Full Service Installer

NAME: _____

TITLE: _____

PHONE: () _____

EMAIL: _____

SIGNATURE: _____

DATE: _____