

REQUEST for QUALIFICATIONS

ALL PROSPECTIVE ARCHITECTURAL / ENGINEERING / GENERAL CONTRACTING FIRMS

INVITATION for QUALIFICATIONS HEALING GARDEN ENTRY VESTIBULE

Grady Health System Department of Facilities Development is soliciting "Qualifications" A/E/C services for the medium design and construction of a new +/-750 s.f. Healing Garden Entry Vestibule. A brief overview of the project is further into this document.

The project will be located at the South Tower/Main Lobby Pratt Street Entry to Grady Memorial Hospital.

- 80 Jesse Hill Jr. Drive, SE, Atlanta, GA 30303.

All A/E/C firms planning to partner and submit a proposal must be pre-qualified. To become qualified, please submit a qualifications package meeting the following requirements:

- List of three to five design-build projects of similar size and scale.
- Brief narrative of each of the referenced projects.
- Organization chart of your team
- One page CV or resume of each team member.

Additionally, registration with VendorMate and TIER 1 Diversity forms must also be completed in order to be considered pre-qualified.

Please submit qualifications to George Smith by email at gcsmith@gmh.edu by C.O.B. Friday, August 20, 2021. You will be notified by Wednesday, August 25, 2021, if you have met the threshold for being pre-qualified.

HEALING GARDEN ENTRY VESTIBULE - \$ 650K



SCOPE DEFINITION:

- PARTIAL DEMOLITION OF EXISTING BUILDING & STRUCTURE
- PARTIAL LANDSCAPE DEMOLITION
- CONSTRUCTION OF NEW "STOREFRONT" VESTIBULE/LOBBY
- NEW FLOORING
- PTAC A/C

COST ESTIMATE:

CONSTRUCTION	\$ 510,000
FLOORING	\$ 10,000
DESIGN	\$ 55,000
INCENTIVE	\$ 0
EQUIPMENT	\$ 0
FURNITURE	\$ 0
CONTINGENCY	\$ 75,000
SUBTOTAL	\$ 650,000

TIMELINE:

CONSTRUCTION CAN COMMENCE IN 12 WEEKS.

THE DURATION IS APPROXIMATELY 10 WEEKS.

TOTAL 24 WEEKS

PLAN NOTES:

1. **NEW VESTIBULE**
EXTEND NEW VESTIBULE OVER TO BUILDING EDGE. NO HAS BEEN IDENTIFIED PROGRAM FOR SPACE.
2. **MODIFICATIONS TO HEALING GARDEN**
3. MAIN LOBBY/ATRIUM [NOT IN SCOPE]
4. ADJACENT SICKLE CELL DEPARTMENT [NOT IN SCOPE]
5. ADJACENT PHARMACY DEPARTMENT [NOT IN SCOPE]

DISRUPTION:

- TEMPORARY CLOSURE OF EXISTING ENTRY & STAIRWELL EXTERIOR DISCHARGE

PRATT STREET

HEALING GARDEN

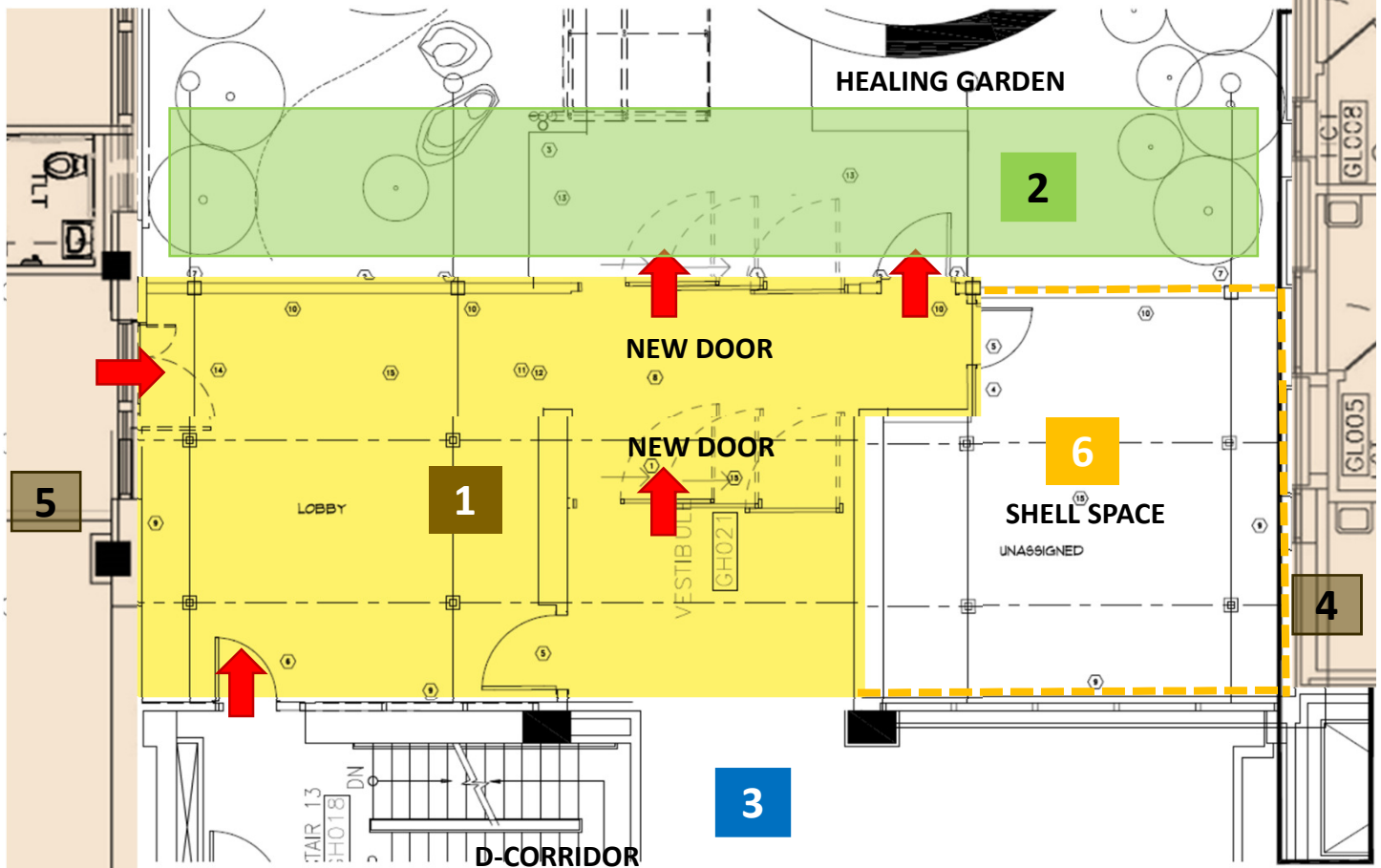

Local, Small Economically Disadvantaged Business Utilization

It is an overall objective of The Grady Memorial Hospital Corporation, d/b/a Grady Health System (GHS) to encourage involvement by local, small, economically disadvantaged contractors and suppliers in business activities generated by GHS®, while assuring that such activities will be conducted in accordance with all applicable laws. It is the declared policy and intent of GHS® to strive to maximize participation of local, small, economically disadvantaged businesses through all business contracting opportunities. GHS® is committed to ensuring that local, small, economically disadvantaged businesses are given every opportunity to participate in contracting opportunities.

GHS® prohibits discrimination on the basis of race, color, gender, religion, national origin, or disability in connection with employment of any person, or the award of any contract. GHS® will provide equal opportunities without regard to race, color, gender, religion, national origin, or disability, by requiring that any vendor doing business with GHS® provide equal opportunity to persons and businesses employed by, or contracting with the supplier of products and services to GHS®.

GHS® expects that the policies, programs and practices of its vendors/contractors are carried out in an equitable fashion and that local (Fulton County, DeKalb County, State of Georgia), small and economically disadvantaged business enterprises are afforded an equitable opportunity to share in contract/subcontract opportunities.

These documents are considered a part of and should be submitted with the qualifications package. Failure to provide the requested information will result in the proposal being determined non-responsive.

- **Screen shot or copy of Vendormate certificate**
- **Completed TIER 1 Diversity form**
- **Certificate verifying TIER 1 diversity.**
- **List of three to five design-build projects of similar size and scale.**
- **Brief narrative of each of the referenced projects.**
- **Organization chart of your team**
- **One page CV or resume of each team member.**

PROCESS FOR SELECTION

A selection team will evaluate each qualification submitted and score the team member. The scores will be made available upon request for your team following pre-qualification

GHS-FD reserves the unqualified right to request additional information or meetings with any architect, engineer, or contractor.

Your company wishes to be pre-qualified as a:

- ☐ Architect
- ☐ Engineer
- ☐ General Contractor

NAME: _____

TITLE: _____

PHONE: () _____

EMAIL: _____

SIGNATURE: _____

DATE: _____