

## REQUEST for QUALIFICATIONS

### ALL PROSPECTIVE MANUFACTURING FIRMS AND SUPPLIERS

#### INVITATION for QUALIFICATIONS

#### GHS-FD Project #: GRADY BIOSAFETY CABINETS, HOODS, AND REFRIDGERATION FOR LAB 21502

The Grady Memorial Hospital laboratory is accredited by the College of American Pathologist (CAP). The clinical laboratory offers chemistry, hematology, microbiology and blood bank services, as well as specimen collection services (phlebotomy). Laboratory services are computer linked so that physicians and staff have immediate access to complete tests. As Grady inpatient capacity grows more demands will be placed on a modernized Hospital lab to deliver more and more test results to support the GRADY mission. GRADY patients depend on laboratory tests. According to CDC, "70% of today's medical decisions depend on laboratory test results" showing the important role of clinical laboratories in today's healthcare system. As we grow bed capacity factors like not receiving test results on time can cause extended length of stay and even delayed diagnosis, which in turn can cause harm. The hospital lab is approximately 21,071 SF in its current configuration. The modernization of this critical space will remain in its current footprint, less some offices, which may be displaced into adjacent areas.

#### Phase 1 Core Lab, Hematology, Genetics Lab, & specimen receiving

Grady has purchase a new Automation line and intends to place this new automation line within the Northward edge. To prepare for this transformation the space will receive a full gut renovation from the Northward edge all of the way to the interior circulation corridor. New space will be rebuilt to the concept plan shown installing OPCI utility walls to allow critical utilities to be brought to the testing areas and OPOI benching will connect along the length of the walls.

#### Phase 2 Molecular testing, Microbiology, and BSL III labs

Once the new automation line has been brought into use and validated Grady intends to remove the existing line automation and vacate the Southward section of the hospital lab. This space, like Phase 1, will receive a full gut renovation from the building edge all of the way to the interior circulation corridor (less existing microbiology lab. New space will be rebuilt to the concept plan shown installing OPCI utility walls to allow critical utilities to be brought to the testing areas and OPOI benching will connect along the length of the walls.

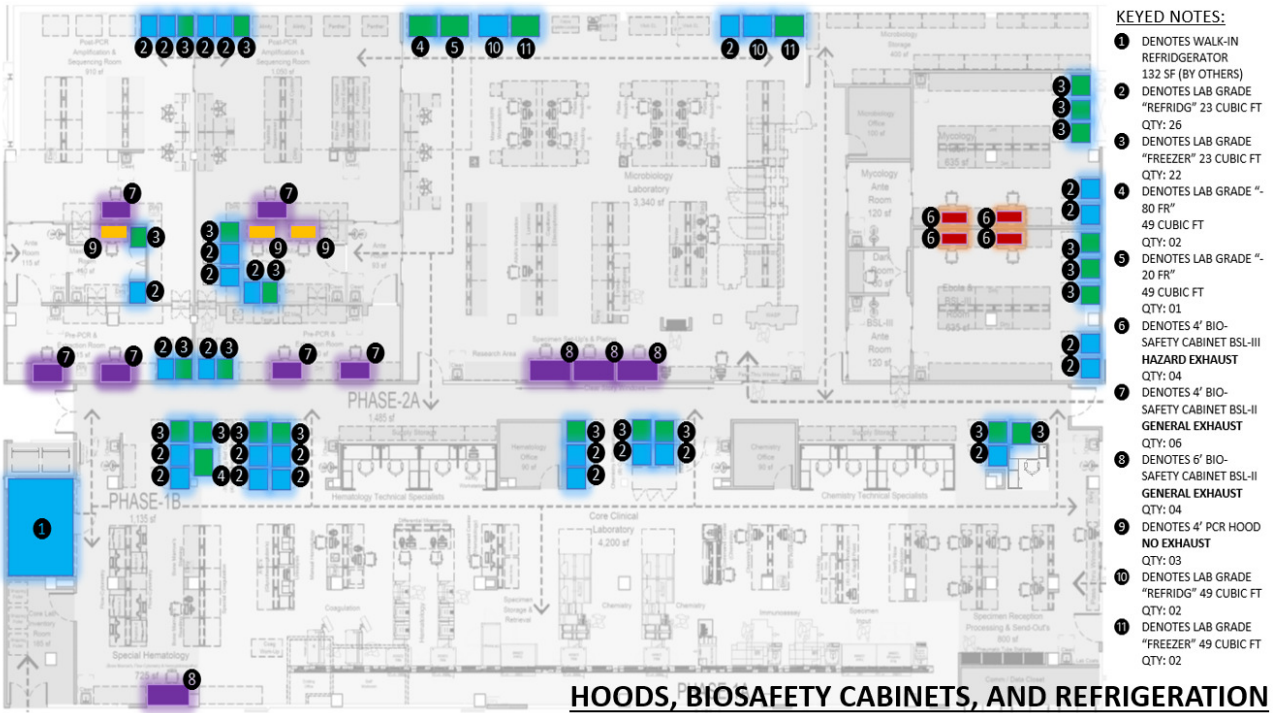

Facilities Development is soliciting "Qualifications" for BIOSAFETY CABINETS, HOODS, AND REFRIDGERATION.

All firms and/or manufacturers planning to submit a proposal must be pre-qualified or submit qualifications for consideration. To become qualified, please submit a qualifications package meeting the following requirements:

- Capabilities – Must be experienced with designing and building healthcare occupancy improvements within an active healthcare setting, performing field verifications without interruption to the facility.
- List of three to five healthcare Inpatient, Critical/Intensive Care projects of similar size and scale.
- Brief narrative of each of the referenced projects.



### **Local, Small Economically Disadvantaged Business Utilization**

It is an overall objective of The Grady Memorial Hospital Corporation, d/b/a Grady Health System (GHS) to encourage involvement by local, small, economically disadvantaged contractors and suppliers in business activities generated by GHS®, while assuring that such activities will be conducted in accordance with all applicable laws. It is the declared policy and intent of GHS® to strive to maximize participation of local, small, economically disadvantaged businesses through all business contracting opportunities. GHS® is committed to ensuring that local, small, economically disadvantaged businesses are given every opportunity to participate in contracting opportunities.

GHS® prohibits discrimination on the basis of race, color, gender, religion, national origin, or disability in connection with employment of any person, or the award of any contract. GHS® will provide equal opportunities without regard to race, color, gender, religion, national origin, or disability, by requiring that any vendor doing business with GHS® provide equal opportunity to persons and businesses employed by, or contracting with the supplier of products and services to GHS®.

GHS® expects that the policies, programs and practices of its vendors/contractors are carried out in an equitable fashion and that local (Fulton County, DeKalb County, State of Georgia), small and economically disadvantaged business enterprises are afforded an equitable opportunity to share in contract/subcontract opportunities.

**These documents are considered a part of and should be submitted with the qualifications package. Failure to provide the requested information will result in the proposal being determined non-responsive.**

- **Screen shot or copy of Vendormate certificate**
- **Completed TIER 1 Diversity form**
- **Certificate verifying TIER 1 diversity.**
- **List of three to five design-build projects of similar size and scale.**
- **Brief narrative of each of the referenced projects.**

**PROCESS FOR SELECTION**

A selection team will evaluate each qualification submitted and score the team member. The scores will be made available upon request for your team following pre-qualification

GHS-FD reserves the unqualified right to request additional information or meetings with any architect, engineer, or contractor.

Your company wishes to be pre-qualified or qualified as a:

- REFRIDGERATION MANUFACTURER
- BSC MANUFACTURER
- HOOD MANUFACTURER
- SUPPLIER
- OTHER COMPLIMENTARY PRODUCTS

NAME: \_\_\_\_\_

TITLE: \_\_\_\_\_

PHONE: ( ) \_\_\_\_\_

EMAIL: \_\_\_\_\_

SIGNATURE: \_\_\_\_\_

DATE: \_\_\_\_\_