



REQUEST for QUALIFICATIONS

October 7, 2022

ALL PROSPECTIVE ARCHITECTURAL / ENGINEERING / GENERAL CONTRACTING FIRMS

INVITATION for QUALIFICATIONS

GRADY BED EXPANSION

BUNDLE 1

NINTH AND TENTH FLOOR A/B-WING / GRADY MEMORIAL HOSPITAL

BUNDLE 2

NINTH, TENTH, ELEVENTH, AND TWELVETH FLOORS C/D-WING / GRADY MEMORIAL HOSPITAL

BUNDLE 3

SEVENTH, NINTH, TENTH, ELEVENTH, TWELVETH FLOORS E WING

FOURTEENTH AND FIFTEENTH FLOORS A/B/E WING

Grady Health System Department of Facilities Development is soliciting “Qualifications” A/E/C services to *increase patient capacity.*

- *Bundle 1 is a backfill of existing space in the West Tower, following the relocation of the Georgia Cancer Center of Excellence to the Correll Pavilion in January, 2023. We anticipate this space to yield 52 critical care beds, all private.*
- *Bundle 2 is a backfill of existing space in the East, following the relocation of support functions. We anticipate this space to yield 122 acute care beds, all private except for two semi-private rooms per floor.*
- *Bundle 3 enables the relocation of support functions from the East Tower.*

This is a multiple phased effort.

We anticipate work to commence in December for select portions of this overall effort.

Work is organized into three separate bundles in order to advantage redundancy of the planned renovations and allow multiple design and construction efforts to commence and proceed concurrently.

The primary scope includes

- construction of two new Critical Care units,
- renovations to two existing Med -Surg units,
- construction of four new Med-Surg units,
- construction of seven new office and support areas supporting this inpatient growth, and
- infrastructure supporting this inpatient growth.

A brief overview of the project is further into this document.

The project will be located in the main hospital at 80 Jesse Hill Jr. Drive, SE, Atlanta, GA 30303.

**INVITATION for QUALIFICATIONS
GRADY BED EXPANSION
FLOORS NINE TO TWELVE
OCTOBER 7, 2022**

All A/E/C firms planning to partner and submit a proposal must be pre-qualified or submit a qualification to receive consideration.

To become qualified, please submit a qualifications package meeting the following requirements:

- List of three to five design-build projects of similar size and scale.
- Brief narrative of each of the referenced projects.
- Organization chart of your team
- One page CV or resume of each team member.

Additionally, qualification requires that Health System Diversity forms (posted separately), and registration with VendorMate, be completed and included in your response.

Please submit qualifications to George Smith by email, at gcsmith@gmh.edu, no later than Monday, October 17th @ 10:00AM. You will be notified by Tuesday, October 18th if you have met the threshold for being qualified.

Regrets will be notified week of October 24th.

A list of pre-qualified design and construction firms follows:

ARCHITECTS

HKS
May
Moody Nolan
PFA
TVS

ENGINEERS

IMEG
RMF Engineering
SSR
TLC
WSP

CONTRACTORS

Brasfield Gorrie
Turner
McCarthy Brothers

A list of pre-qualified design partners are also listed below.

EQUIPMENT PLANNING

Anchor Planning

Technology Consultant

J&A

Commissioning Cx

[Open for submission](#)

A preproposal meeting will be held on-site Wednesday, October 19, 2022, at 1:00 p.m., with the location forwarded with notification of being qualified.

All proposal presentations will be made, by team, for each Bundle Tuesday, November 1, 2022. Time and location to be determined.

PROJECT DEFINITION – CONCEPT PACKAGE PAGE(S):

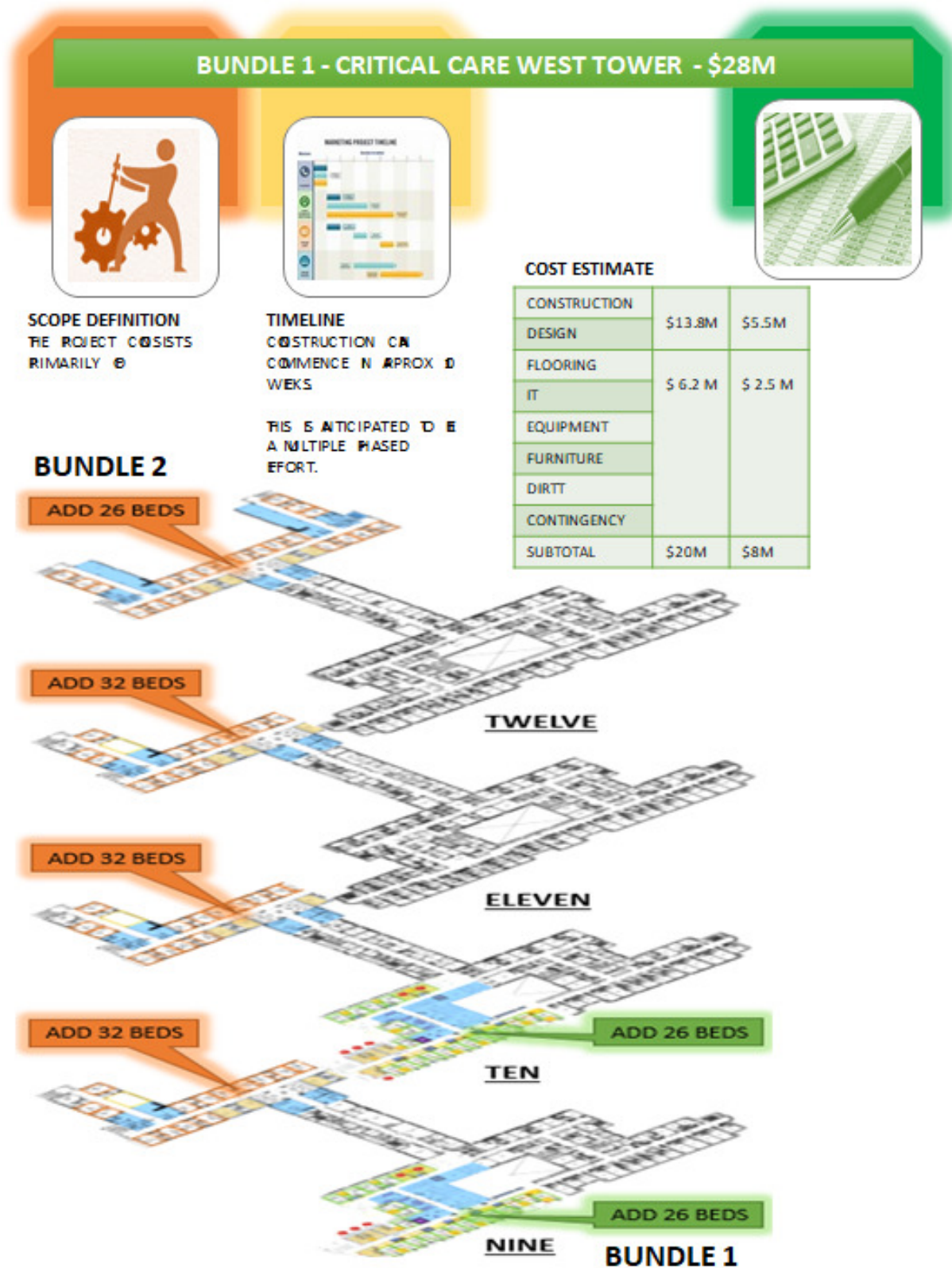

PROJECT DEFINITION – CONCEPT PACKAGE PAGE(S):

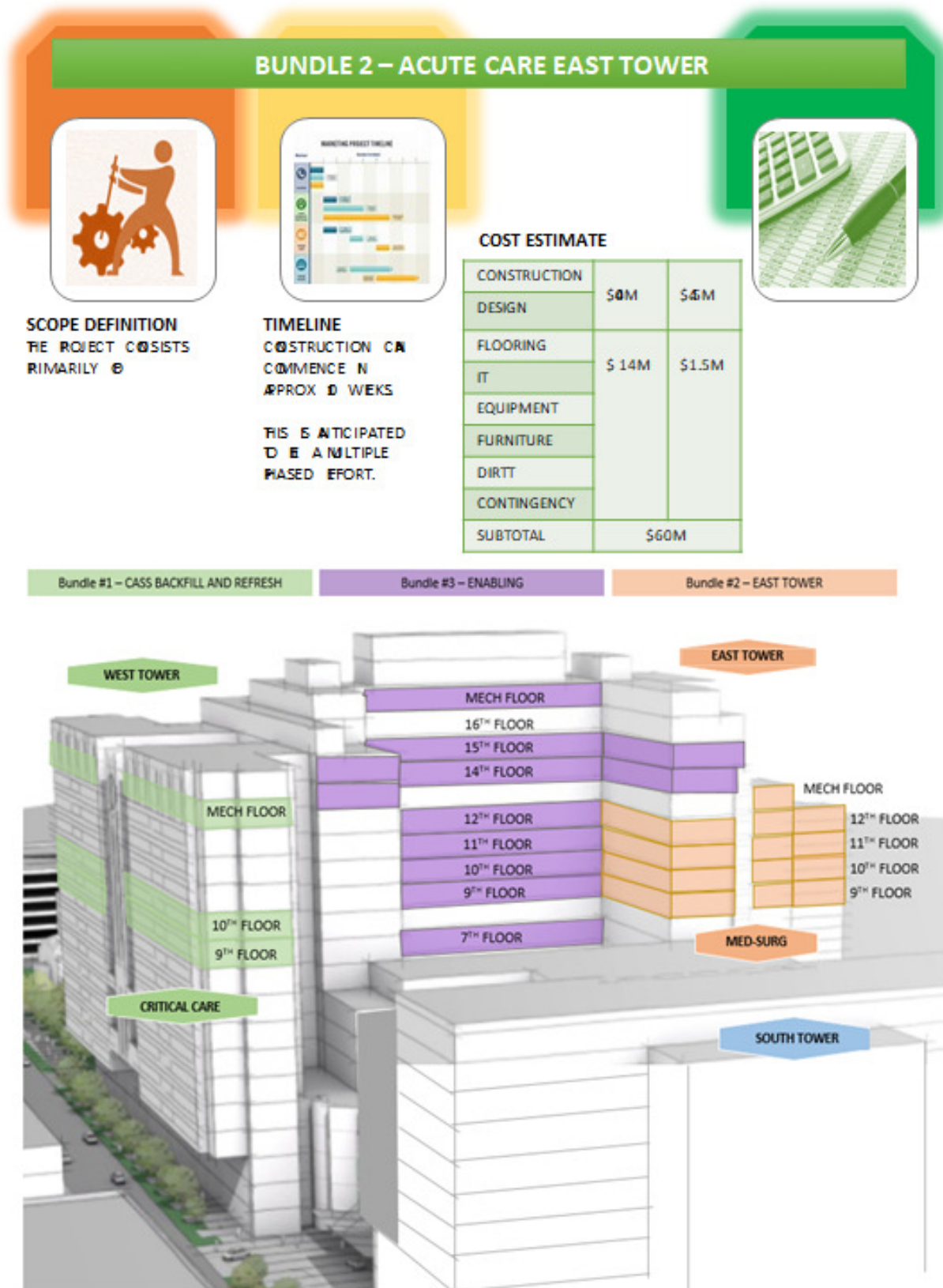

PROJECT DEFINITION – CONCEPT PACKAGE PAGE(S):

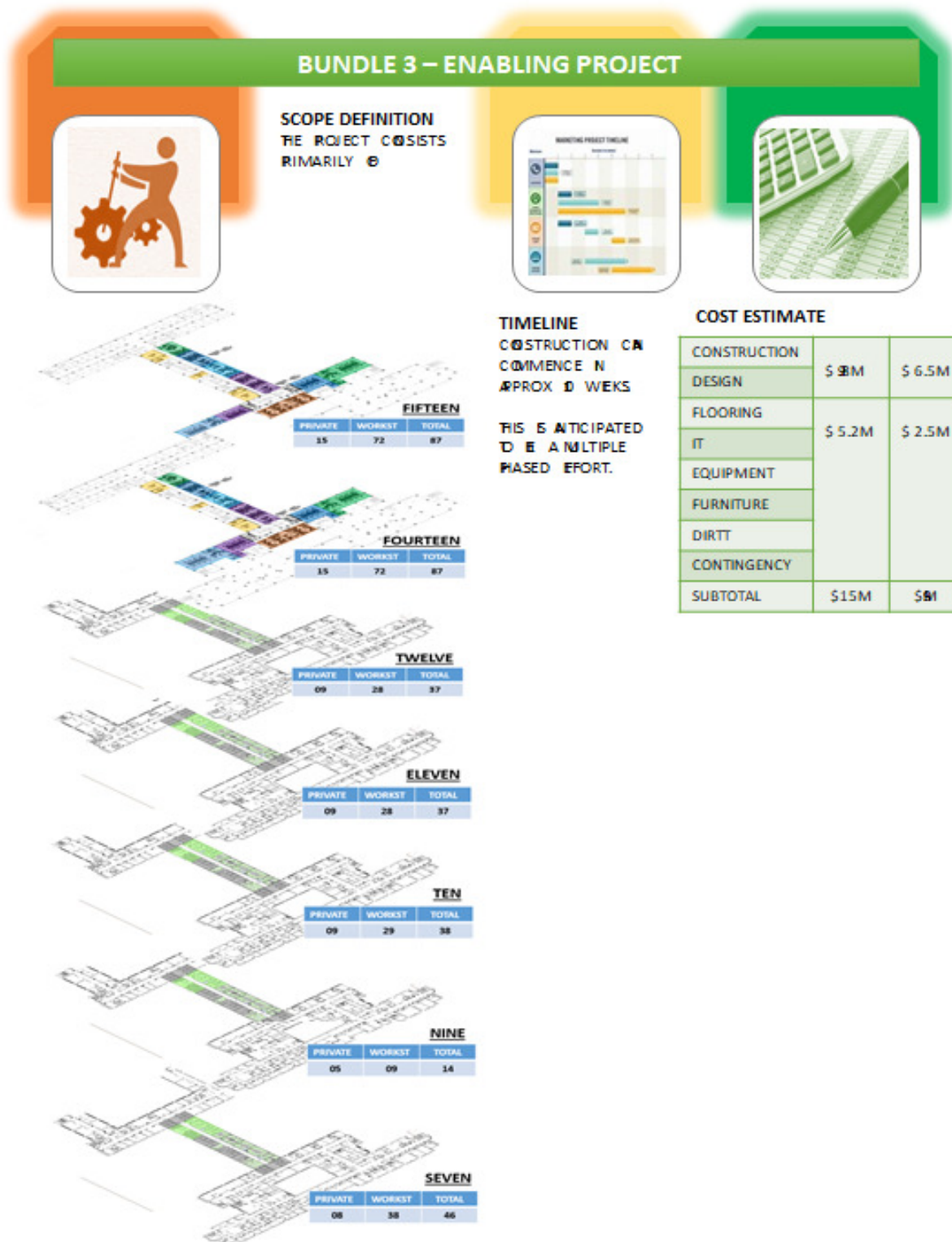

PROJECT DEFINITION – CONCEPT PACKAGE PAGE(S):

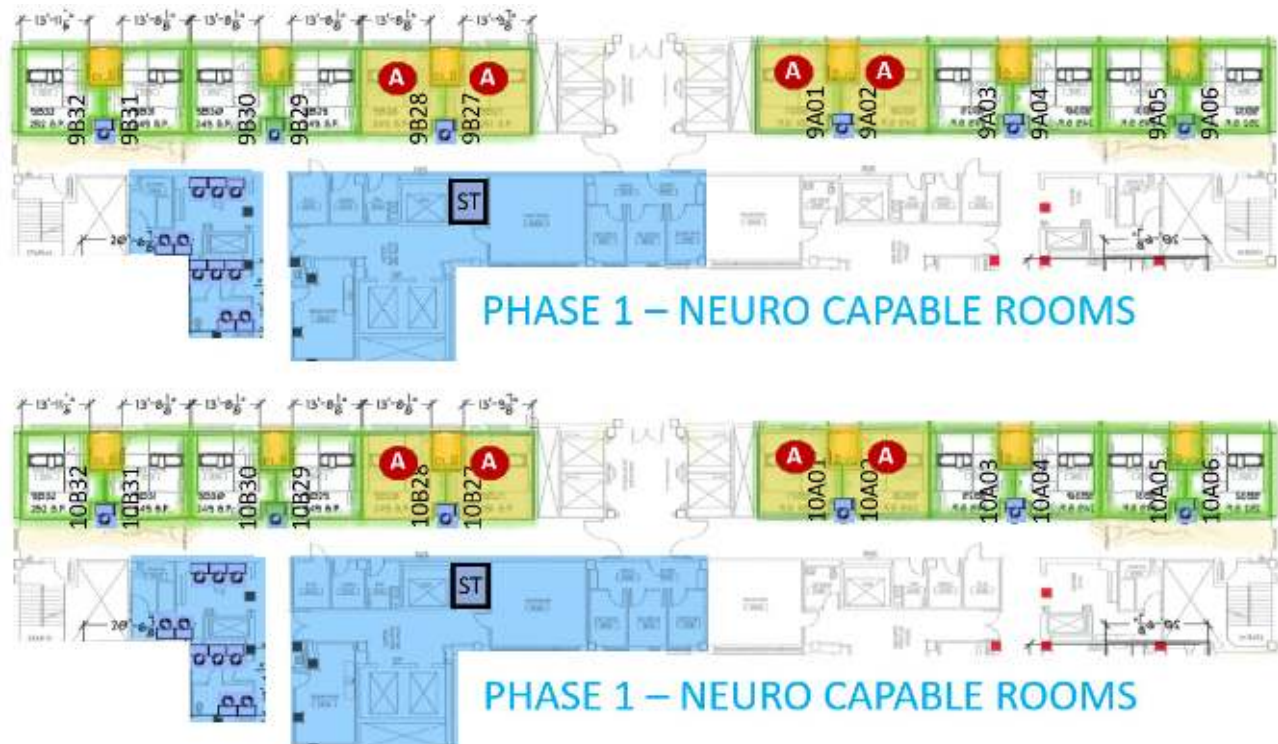

FIGURE 01 – PHASE 1 NEURO FLEXIBLE ROOMS 9A/9B AND 10A/10B [BUNDLE 1]



FIGURE 02 – TYPICAL CRITICAL CARE UNIT 9B/10B [BUNDLE 1]

PROJECT DEFINITION – CONCEPT PACKAGE PAGE(S):

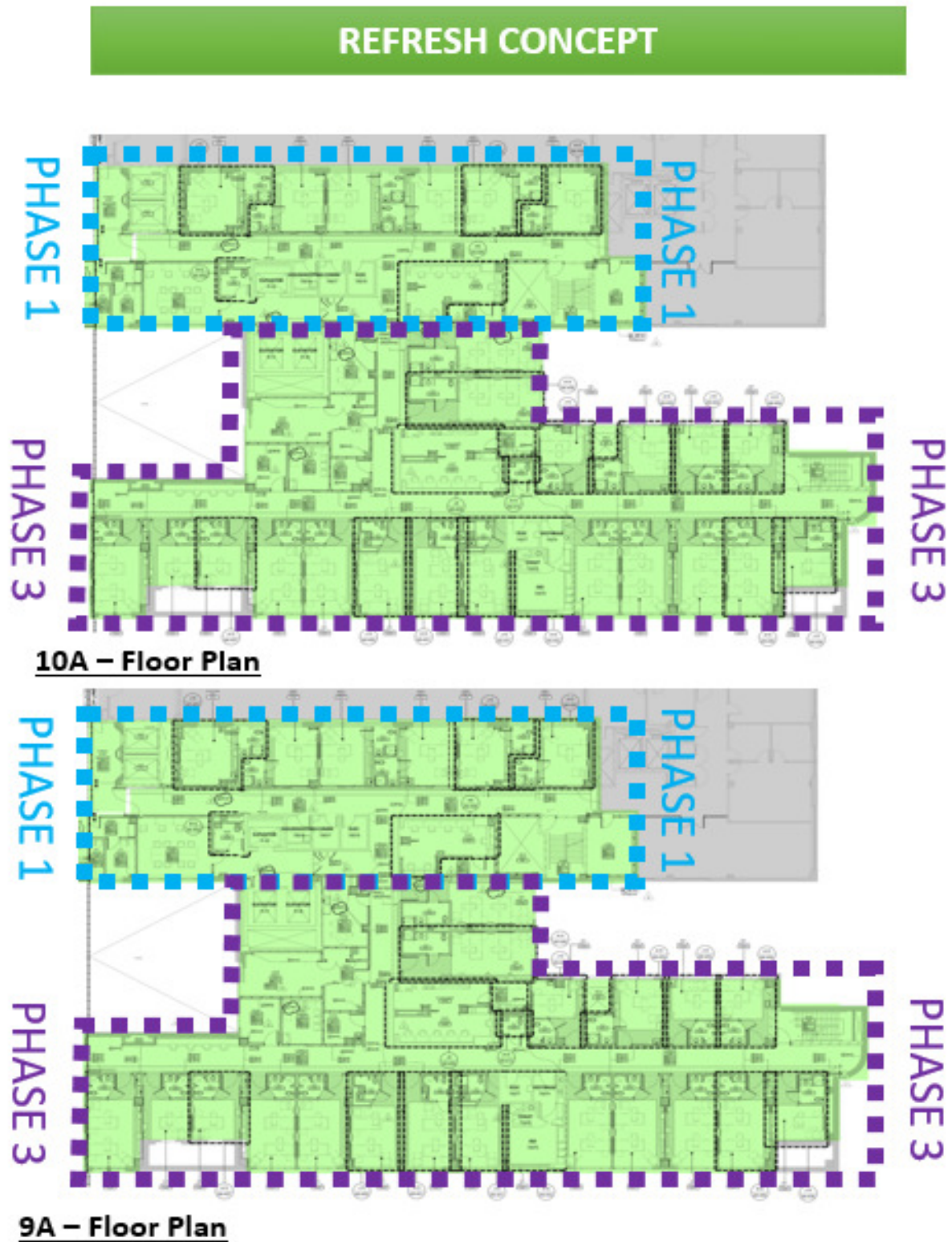

FIGURE 03 – TYPICAL REFRESH UNIT 9A/10A [BUNDLE 1]

PROJECT DEFINITION – CONCEPT PACKAGE PAGE(S):

10th Floor

Building Information:

- 50,669 SF - NET
- 60,968 SF - Gross

Occupants:

Med-Surg Unit

Vacating:

Cancer Center, Research
Labs, Nurse Education

9th Floor

Building Information:

- 50,610 SF - NET
- 60,968 SF - Gross

Occupants:

Med-Surg Unit

Vacating:

Cancer Center, Dialysis

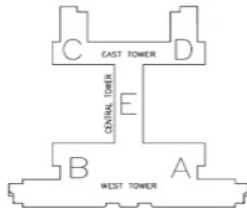

NINTH - TWELFTH FLOOR

PROPOSED BACKFILL STRATEGY - NINTH FLOOR

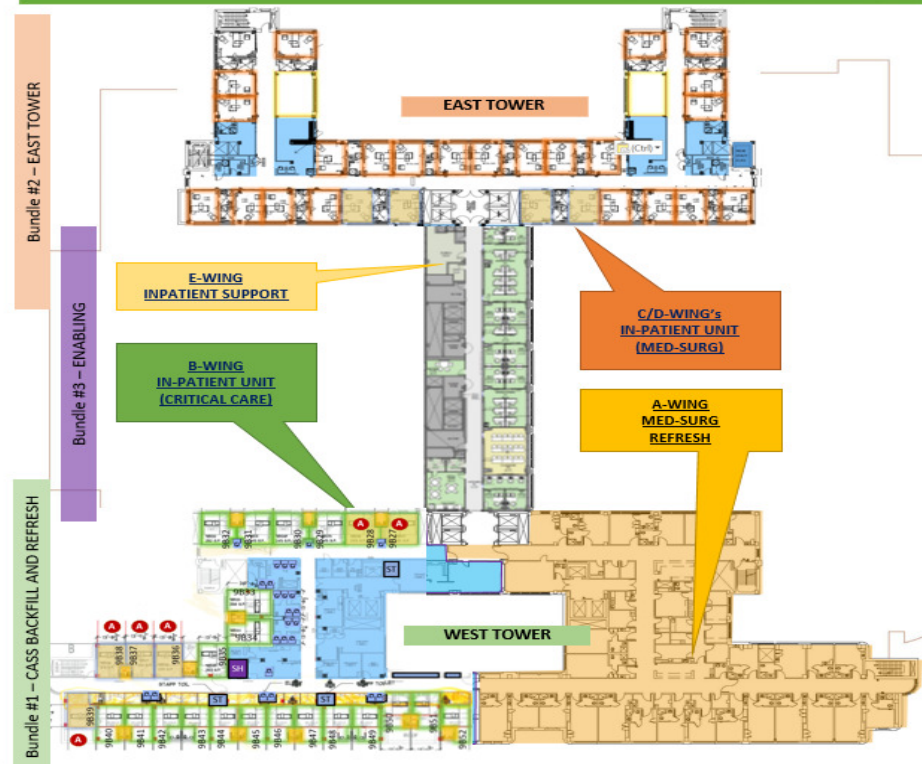

PROPOSED BACKFILL STRATEGY - TENTH FLOOR

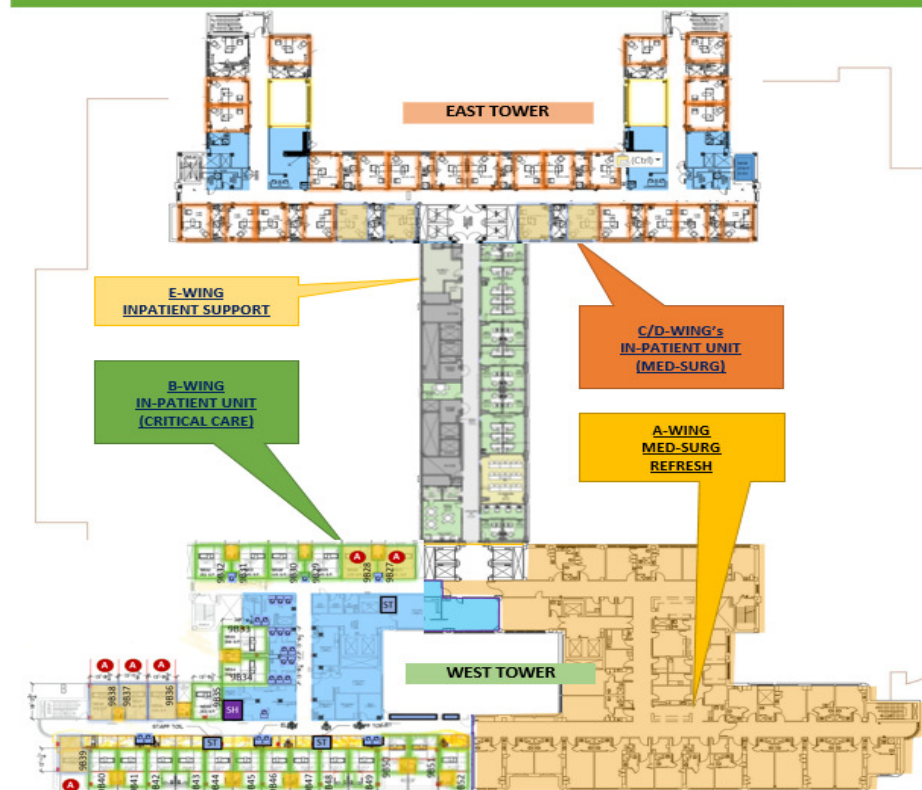

PROJECT DEFINITION – CONCEPT PACKAGE PAGE(S):

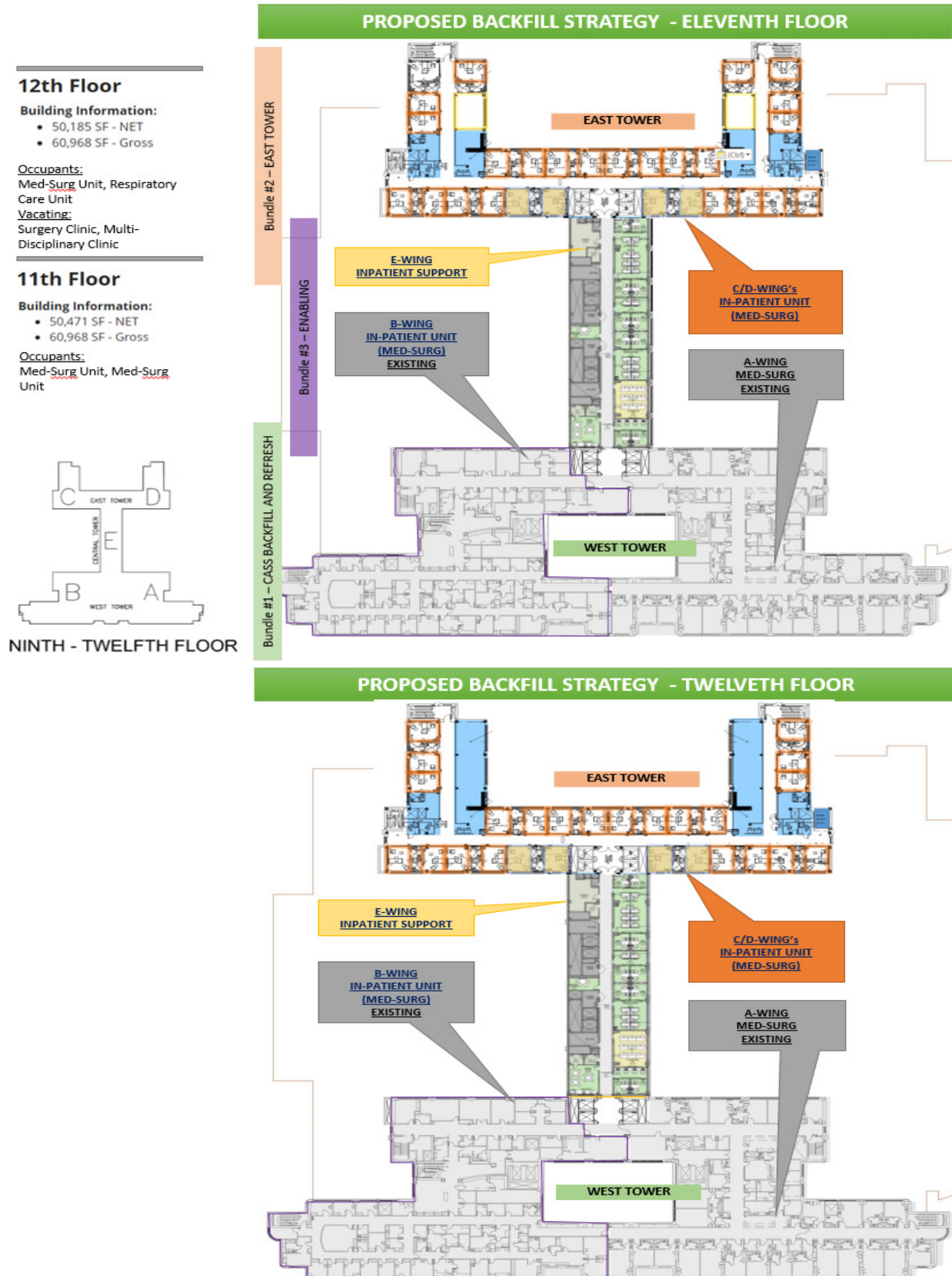

PROJECT DEFINITION – CONCEPT PACKAGE PAGE(S):

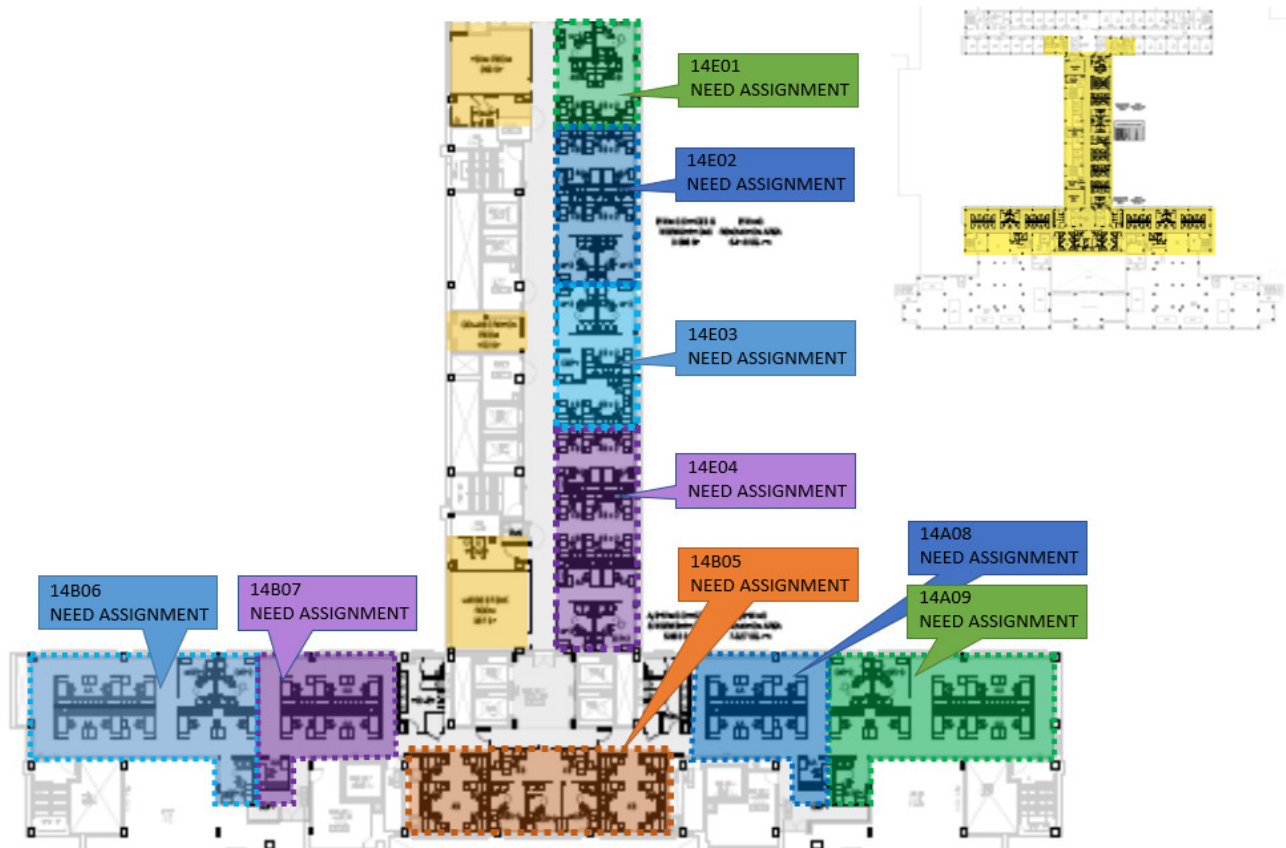

FIGURE 04 – TYPICAL ENABLING FLOOR PLAN 14B/14B/14E

[BUNDLE 3]

PROCESS FOR SELECTION

A selection team will evaluate each qualification submitted and score the team member. The scoring or notes used to make the determination will be made available upon request for your team following completion of this procurement.

GHS-FD reserves the unqualified right to request additional information or meetings with any architect, engineer, or contractor.

Your company wishes to be qualified as:

- ☐ Architect
- ☐ Engineer
- ☐ General Contractor
- ☐ Commissioning Cx

Your company wishes to BE UNDER
CONSIDERATION FOR:

- ☐ **BUNDLE 1**
CRITICAL CARE
- ☐ **BUNDLE 2**
ACUTE CARE
- ☐ **BUNDLE 3**
ENABLING

NAME: _____

TITLE: _____

PHONE: () _____

EMAIL: _____

SIGNATURE: _____

DATE: _____