

**Grady Health System**

# **Scope Development**

Emory ENT & OBGYN Package

Emory ENT & OB/GYN Office and Workrooms

Current – 4E

Existing Notes:

- Area 4E
- Rooms: 4E001, 4E001A, 4E001B, 4E007, 4E009
- Currently being used as office space

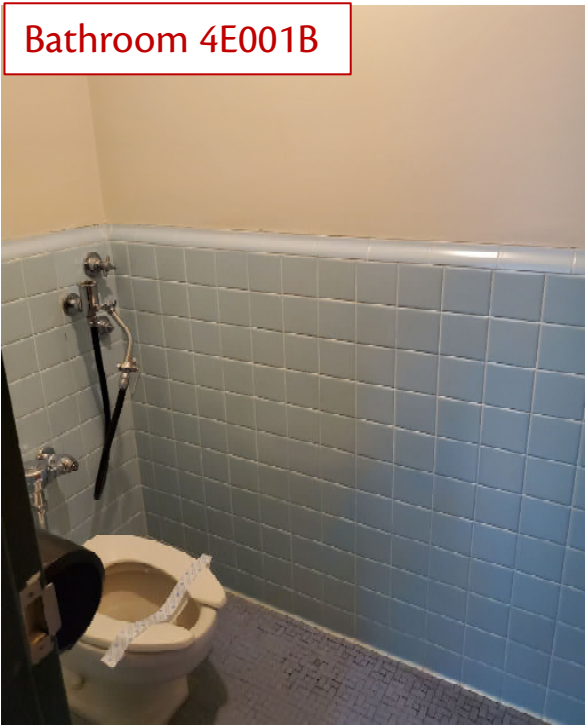
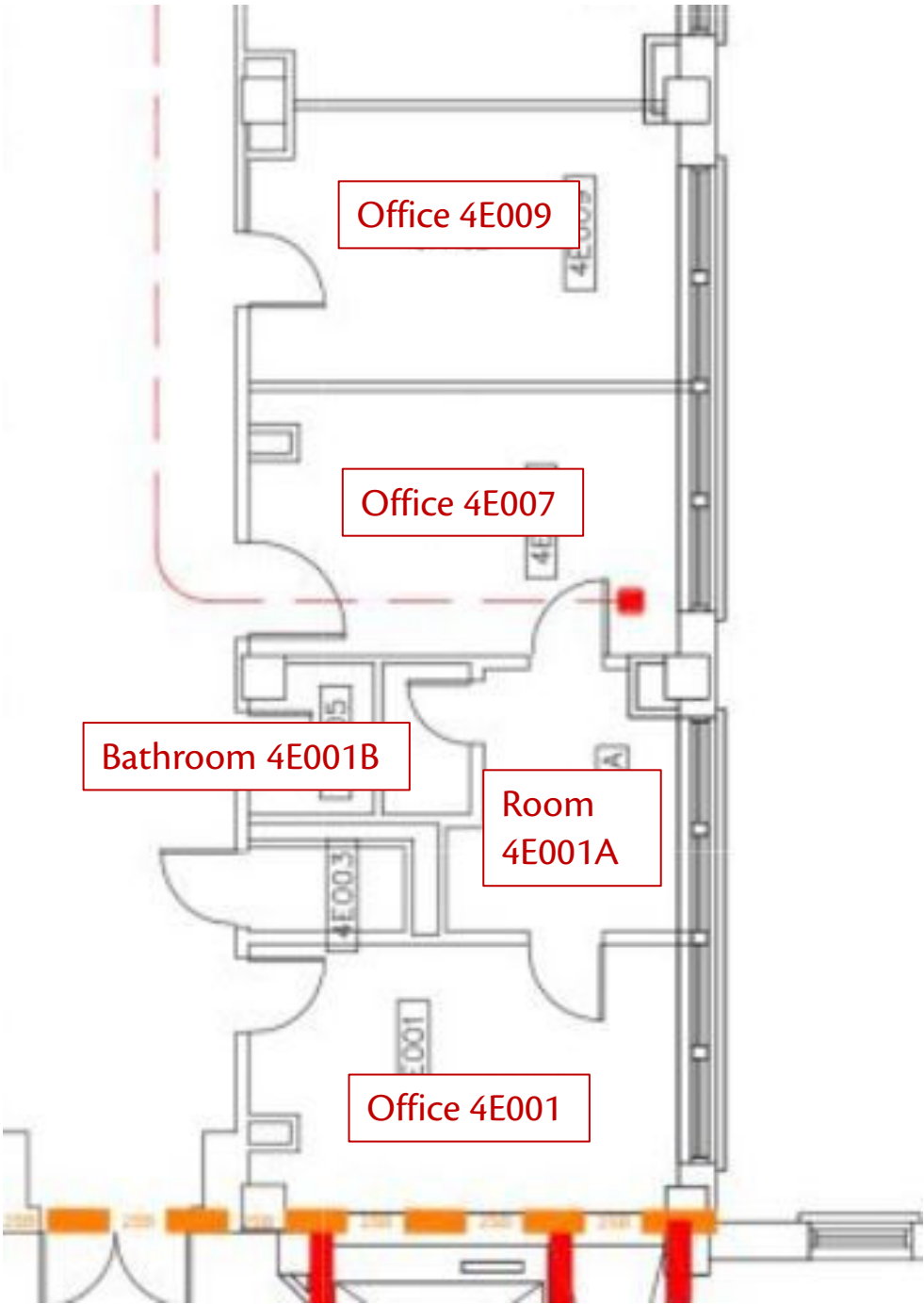

## Emory ENT & OB/GYN Office and Workrooms

### Proposed

Total Renovated Square Footage: 527 SF

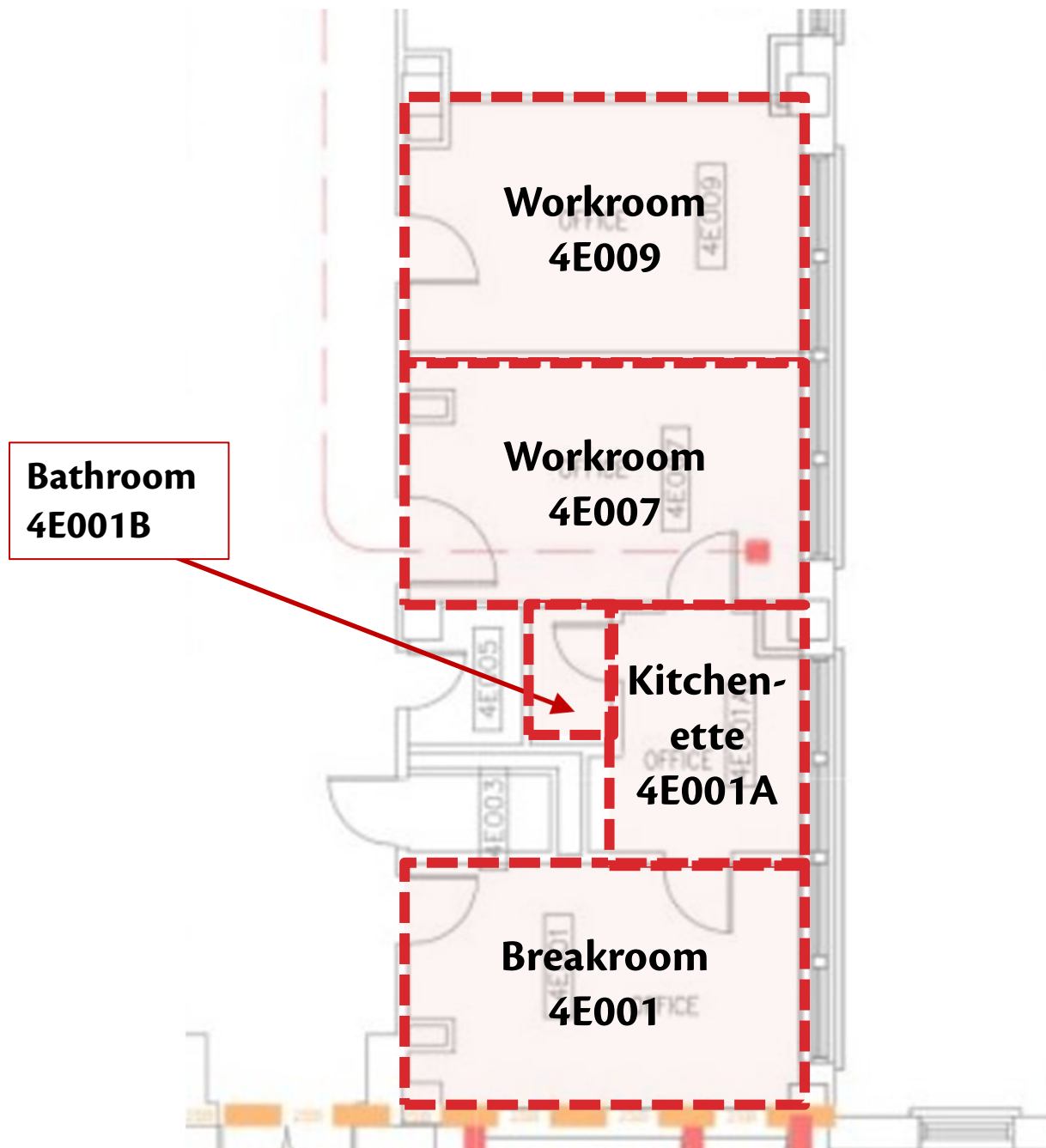

### General Scope Notes:

- **4E009**
  - Renovate workroom 4E009 with new finishes: flooring to receive standard LVT, paint, repair ceiling grid and replace ACT tiles as needed, replace lighting with new LED standard, replace door lockset with new standard (medico) with keypad. Include new sign on exterior of door to match new standard.
  - Add data and electrical as needed in room 4E009 to support the 4 workstations along the perimeter (computers, phones, etc)
  - Add FFE to room 4E009: perimeter workstations using standard furniture solution (per Patrina Crayton), computers, phones, trash cans and other accessories, 1 round table with 4 chairs to center of room, 1 tall and 1 short file cabinets
- **4E007**
  - Renovate workroom 4E007 with some new finishes: paint, repair/ replace ceiling grid and ACT tiles as needed, replace lighting with new LED standard.
- **4E001**
  - Renovate breakroom 4E001 with new finishes: flooring to receive standard LVT, paint, repair ceiling grid and replace ACT tiles as needed, replace lighting with new LED standard.
  - Add FFE to room 4E001: a couch, 4-person breakroom style tables/chairs to match standard (as many as will fit), and 1 wall-mounted cable television.
  - Add data and electrical as needed to room 4E001 to support TV
- **4E001A & B**
  - Repaint bathroom 4E001B
  - Renovate room 4E001A into kitchenette (existing cabinets to remain). Paint room. Add electrical and plumbing as needed to support equipment.
  - Add FFE to kitchenette 4E001A: full size refrigerator, microwave, Keurig coffee maker, combo water/ice dispenser

### Add Alternates:

- Add sink to kitchenette 4E001A



Emory ENT & OB/GYN Office and Workrooms

Proposed

Total Renovated Square Footage: 527 SF

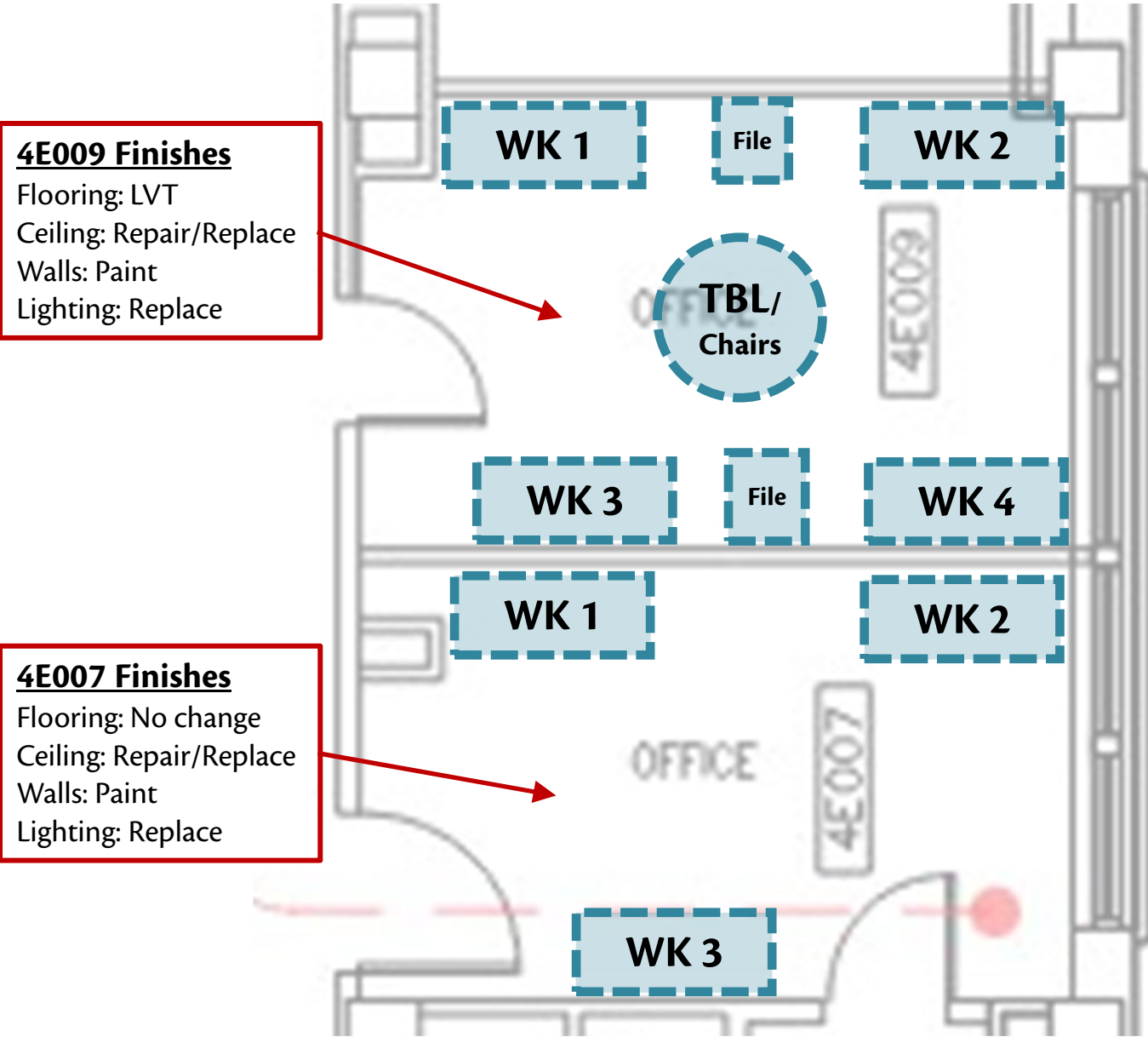

**4E001B Finishes**  
Flooring: No change  
Ceiling: No change  
Walls: Paint  
Lighting: No change

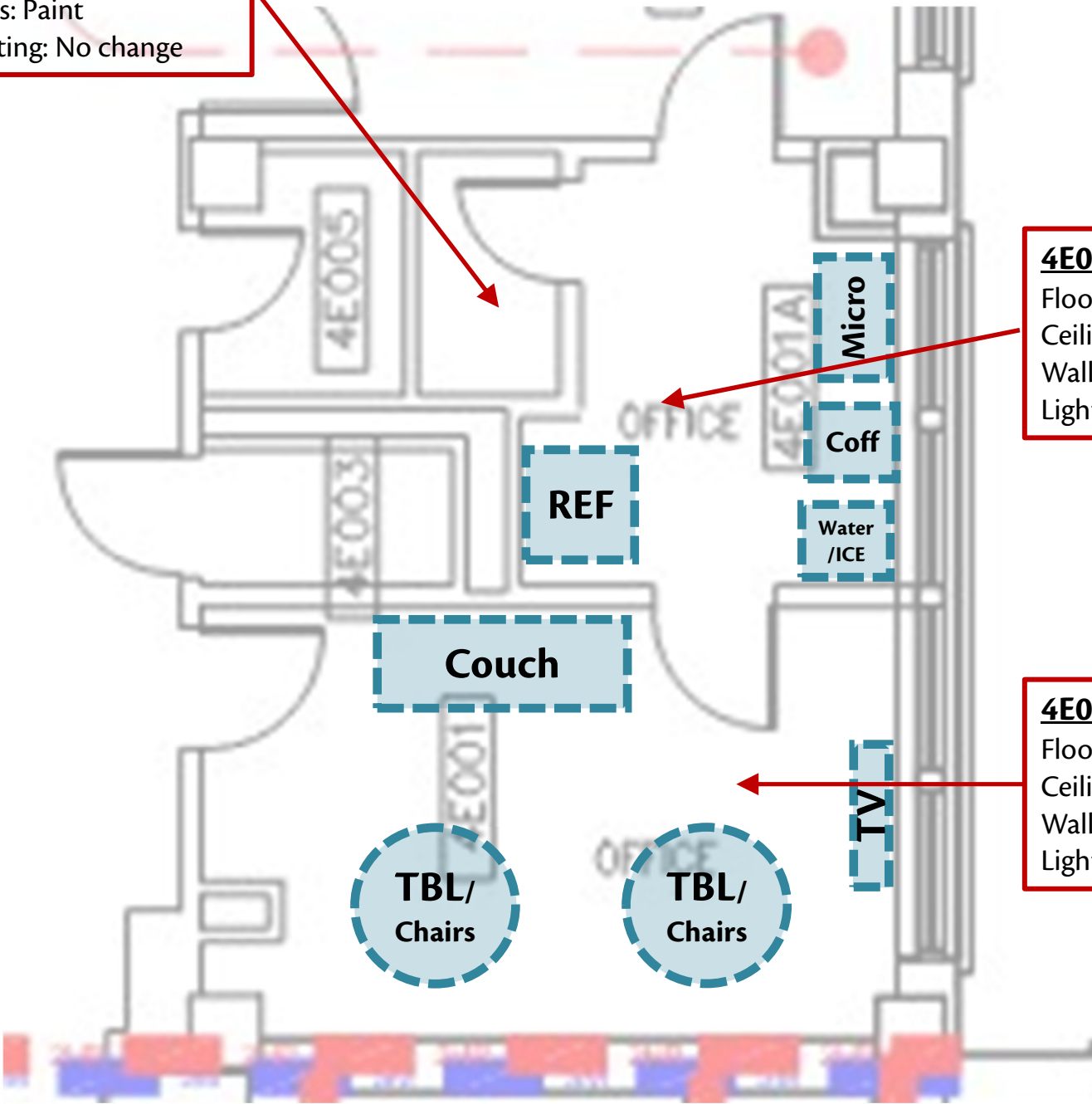

Owner Furnished / Contractor Installed