

Grady Health System

Scope Development

EVS Break Room Package

EVS Break Room

Current – Basement A & B

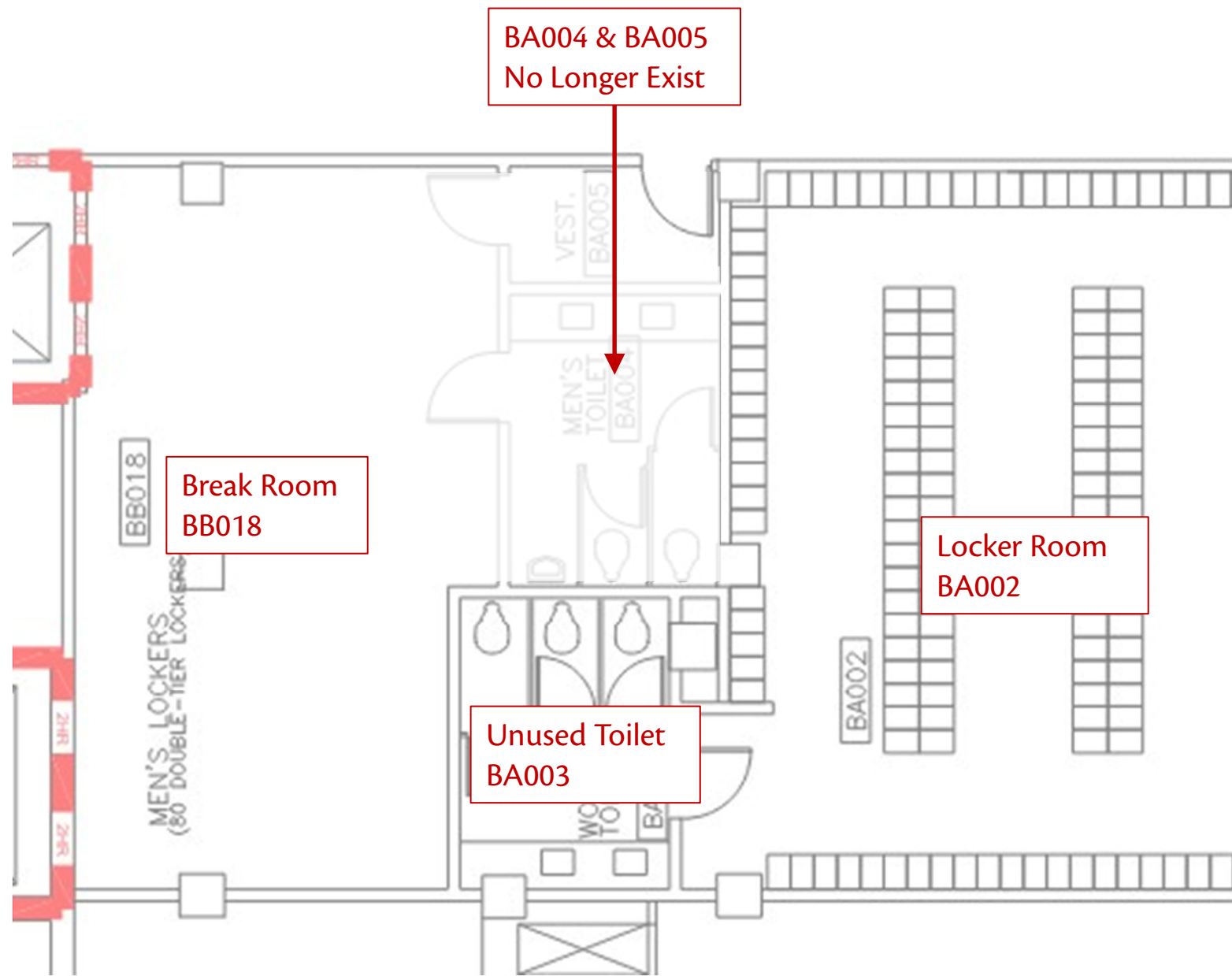

Existing Notes:

- Area BA & BB
- Rooms: BA005, BA004, BA003, BA002, BB018
- Currently being used as a break room, locker room and unused bathroom



EVS Break Room

Proposed

Total Renovated Square Footage: 738 SF

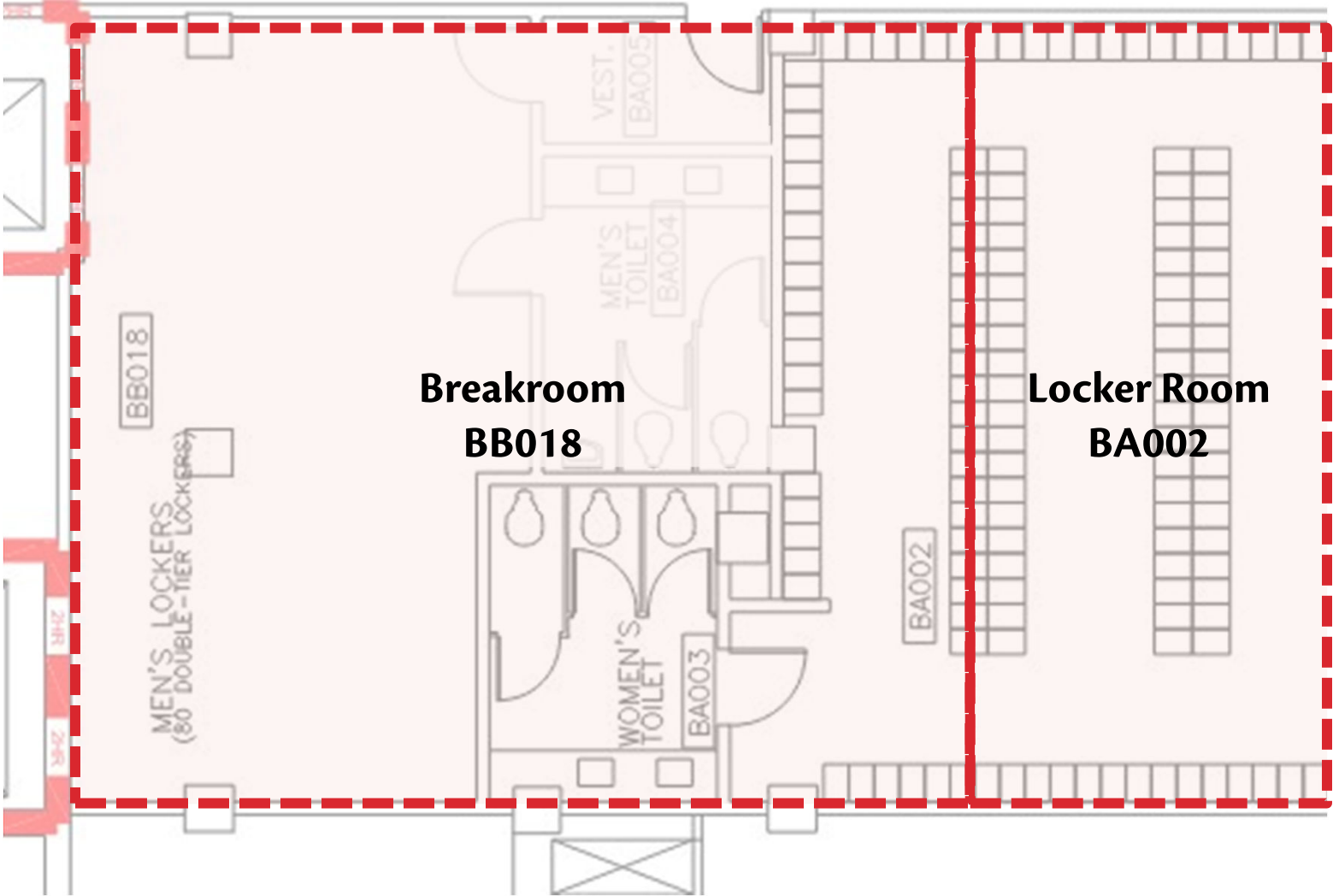



General Scope Notes:

- **BA003**
 - Demolish and renovate unused toilet room BA003 to be part of expanded Break Room BB018.
- **BA002**
 - Renovate locker room BA002 to reduce size for expanded break room BB018 (remove double sided locker aisle)
 - Wall lockers located on demoed dividing wall to be relocated onto new dividing wall
 - Replace and repair ceiling tiles and grid as needed.
 - Patch and match paint
 - Relocate lighting and air supply/returns to maintain code complying levels in the locker room
- **BB018**
 - Renovate and expand breakroom BB018 with new finishes: flooring to receive standard LVT, paint, new ceiling tile & grid throughout, replace lighting with new LED standard. Include new kitchenette casework with sink.
 - Add FFE to room BB018: 2 new full size refrigerators, 2 new microwaves, combination ice / water dispenser and 4-person breakroom style tables/chairs to match standard (as many as will fit)
 - Relocated existing FFE in room BB018: 2 cable televisions, keurig coffee maker and vending machine.

EVS Break Room

Proposed

Total Renovated Square Footage: 738 SF

-  Owner Furnished / Contractor Installed
-  Contractor Furnished / Contractor Installed

New dividing wall

BB018 Finishes
Flooring: LVT
Ceiling: New tile/grid
Walls: Paint
Lighting: New LED

BA002 Finishes
Flooring: Patch/Match
Ceiling: Patch/Match/Repair
Walls: Patch/Match
Lighting: Relocate
Mech: Relocate

